



FUNCTIONAL SKILLS MATHS & ENGLISH

LEVEL 1 & 2 EXAMS

Functional Skills Maths & English Exams

Exam Centre is a specialist provider of **Functional Skills** qualifications in **Maths** and **English**, offering **City & Guilds** examinations that are fully regulated and **approved by Ofqual**.

Our Functional Skills qualifications are recognised as equivalent to **GCSE grade 4+ (grade C and above)**, providing learners with a credible and nationally accepted route into further education, apprenticeships, and employment.

[BOOK NOW](#)

[LEARN MORE](#)

Online Courses

- ➔ Functional Skills Maths
- ➔ Functional Skills English

Exams

- ➔ Functional Skills **Maths** Level 1 or 2 Exams **in London**
- ➔ Functional Skills **English** Level 1 or 2 Exam **in London**
- ➔ **Online** Functional Skills **Maths** Level 1 or 2 Exams
- ➔ **Online** Functional Skills **English** Level 1 or 2 Exam

***Disclaimer:** The content of this document belongs to the respective awarding body and is shared for educational purposes only, Exam Centre does not claim ownership of this material.*



www.examcentre.co.uk



362 Essex Road
Islington N1 3PD



020 7288 9020

BOOK YOUR FUNCTIONAL SKILLS EXAM NOW!

TQUK Functional Skills Qualification in Maths at Level 2

Examination Past Paper 7

Please complete the details below using black or blue ink. Use **BLOCK CAPITALS**.

Learner Name: _____

Learner Number: _____

Date: _____

Centre Name: _____

Instructions:

- read each question **carefully**
- answer **all** questions
- write your answers **clearly** in the spaces provided
- **check** your answers.

Information:

- this examination has **two** sections. These are clearly labelled
- you are **not allowed** to use a calculator for Section A
- you **are allowed** to use a calculator for Section B
- the **maximum** mark for this examination is 60
- the marks available for each question are shown in **bold** beneath each question.

Items:

- you **will need** a pen with black or blue ink, a pencil, a ruler and an eraser (for diagrams, graphs and charts only)
- you **will need** a basic calculator for Section B only
- you **will need** a protractor
- you **will not** need any other stationery or equipment.

Time allowed:

30 minutes for Section A (Non-calculator)

90 minutes for Section B (Calculator)

Do not open this examination paper until you are told to do so.

For examiner use only

	Marks available	Marks awarded	Second marks
Section A	15		
Section B	45		
Total marks	60		

This page is intentionally left blank.

Past Paper

Section A: Non-calculator

There are **15 marks** available in this section.
You must **not** use a calculator in this section.
You will have **30 minutes** to complete this section.



1. Work out $1.804 + 2.6$

--

Answer	
--------	--

[1]

2. Work out 5×6.248

--

Answer	
--------	--

[1]

Questions continue on the following page

3. This is a scale diagram of a floor plan of a house:

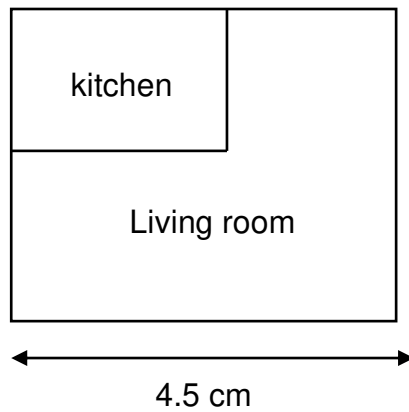

The scale is 1 : 200

Work out the actual length of the living room.

Give the units in your answer.

Answer	

[2]

4. Work out:

$$\frac{1}{4} + \frac{1}{7}$$

--

Answer	
---------------	--

[2]

5. Charlie receives these discount coupons for the same restaurant:

Monday $\frac{1}{6}$ off

Tuesday 16% off

Charlie wants to go to the restaurant on the day which offers the bigger discount.

On which day should Charlie go to the restaurant?

Show how you decide.

--

Answer	
---------------	--

[2]

Questions continue on the following page

6. Work out the value of angle A.

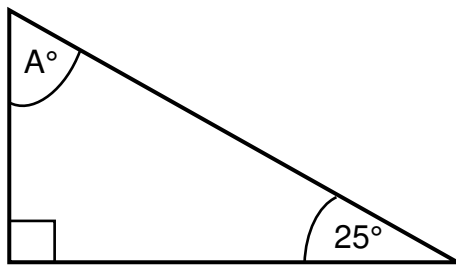

Not drawn to scale

--

Answer

°

[2]

7. A clay pot has:

- mass = 2650 grams
- volume = 1000 cm³

Work out the density of the clay pot.

--

Answer

[2]

8. Riley wants to become a local football coach.

Riley uses this table to find out how much other local football coaches charge:

Coach	A	B	C	D	E	F	G
Charge per hour	£25	£20	£30	£40	£26	£20	£35

Riley uses this formula to work out how much to charge:

$$P = 1.1M$$

Where:

P is the amount Riley will charge per hour in pounds

M is the mode of the numbers in the table

How much will Riley charge per hour?

	Answer	£
--	---------------	----------

[3]

End of Section A.

Section B begins on Page 7.

Past Paper

Section B: Calculator

There are **45 marks** available in this section.
 You **can** use a basic calculator in this section.
 You will have **90 minutes** to complete this section.



1. Write five million three hundred thousand in numbers.

Answer	
---------------	--

[1]

2. Put these numbers in order starting with the lowest:

1 004 682

– 948 750

1 020 845

– 34 589

Show any working here:

Show any working here:				
Answer				
	Lowest			Highest

[1]

Questions continue on the following page

3. Last week it took 2 gardeners 4 hours to mow a field.

This week there will be 5 gardeners available to mow a field of the same size.

The gardeners all work at the same speed.

Their manager thinks that the 5 gardeners will mow the field in less than 1.5 hours.

Is the manager correct?

Show how you decide.

Past Paper	
Answer	

[2]

4. Put these fractions in order starting with the highest:

$2\frac{4}{9}$

$2\frac{5}{6}$

$2\frac{2}{3}$

$2\frac{13}{18}$

Show any working here:

Answer				
	Highest			Lowest

[2]

Questions continue on the following page

5. The diagram shows a square based pyramid:

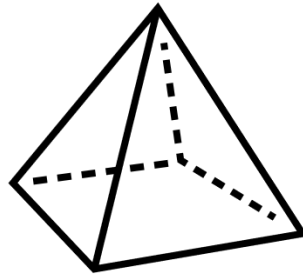

Draw the plan view and side view of the pyramid.

Plan view

Side view

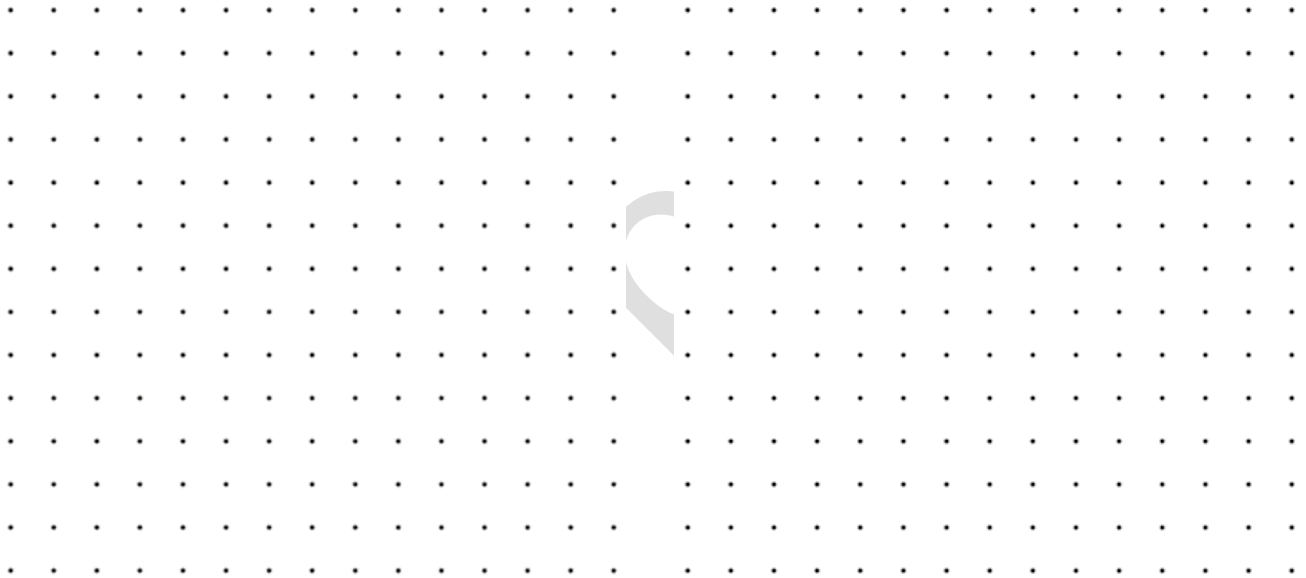

[2]

6. Hansa wants to put a square trampoline in a garden.
One side of the trampoline is shown on this grid:

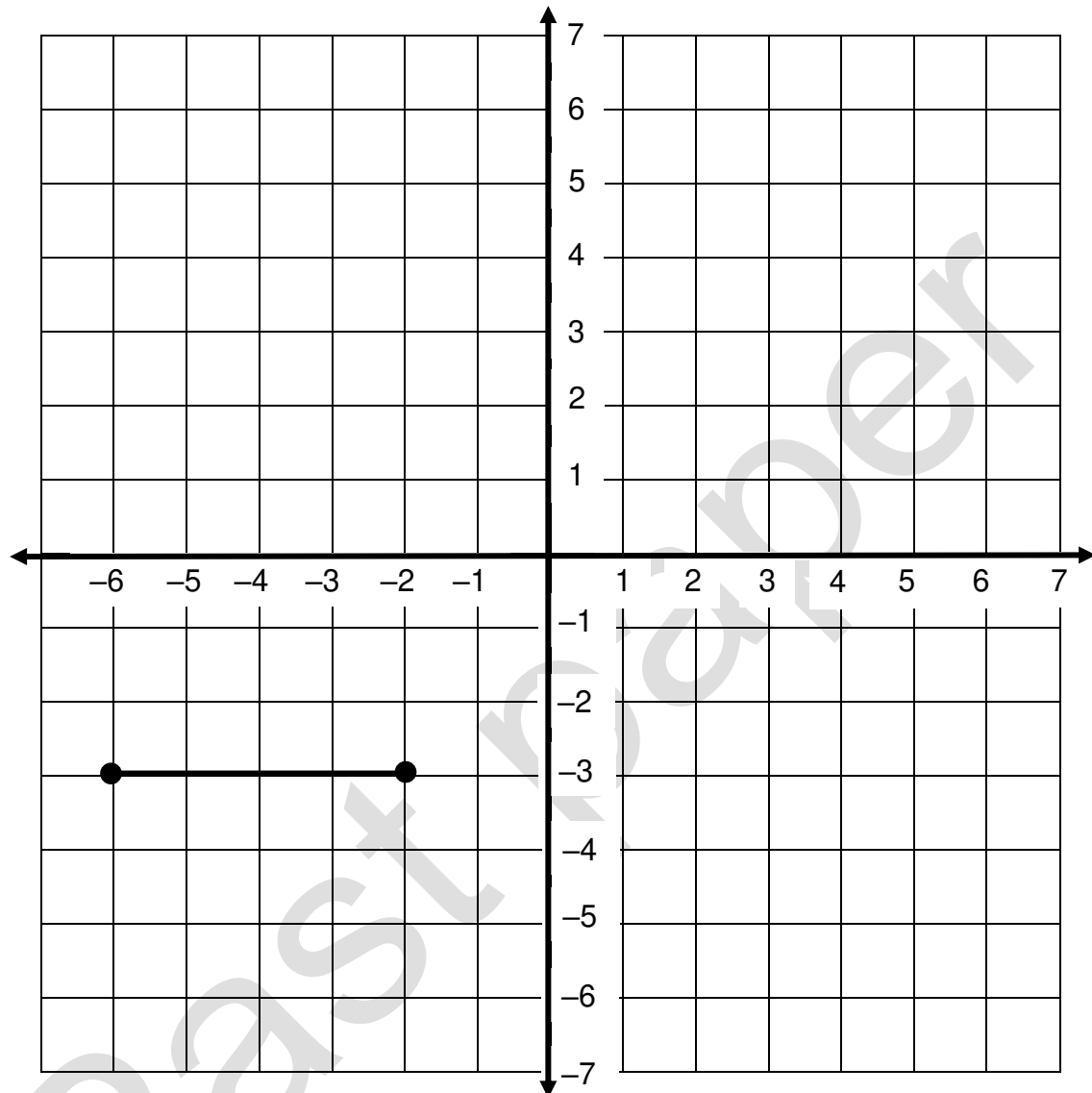

Where could the other **two** corners of the trampoline be placed?

Answer (,) and (,)

[2]

Questions continue on the following page

7. Quinn bought a mobile phone.

The next day, Drew buys the same type of mobile phone in a sale.

Drew got a 32% discount and paid £170 for their phone.

How much more money did Quinn pay for the mobile phone?

--

Answer	£
---------------	----------

[3]

8. This table shows how long Tomi spends on different tasks at work:

Serving customers	210 minutes
Working in warehouse	50 minutes
Paperwork	60 minutes
Stocking shelves	100 minutes

Tomi wants to know what fraction of time is spent doing paperwork.

Tomi works this out to be $\frac{1}{6}$

Has Tomi worked out the correct fraction?

Show how you decide.

Answer area for the question.

Answer

[3]

Questions continue on the following page

9. Bo needs to paint the outside of this cylinder including the top and bottom:

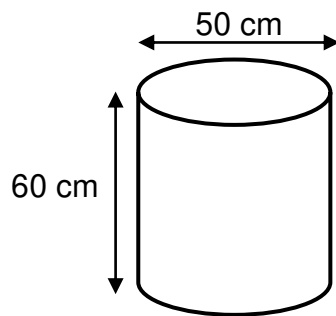

Not drawn to scale

Bo thinks the total area to be painted is less than 15 000 cm²

Is Bo correct?

Show how you decide.

Use $\pi = 3.14$

--	--

Answer	
---------------	--

[3]

10. The table shows how far Alex walked each day for two weeks:

	Monday	Tuesday	Wednesday	Thursday	Friday
Week 1	4 miles	2 miles	5 miles	9 miles	6 miles
Week 2	5 miles	3 miles	6 miles	7 miles	5 miles

Was Alex more consistent in week 1 or week 2?

Give a reason for your answer.

Past paper	
Answer	

[3]

Questions continue on the following page

11. Jamie is planning an event for 280 people.

There will be three different ticket types available.

The ticket types are Standard, Premium and Luxury in the ratio 5 : 3 : 2

Jamie needs to know how many of each ticket type there will be.

Complete the table for Jamie.

Tickets available	
Ticket Type	Number Available
Standard	
Premium	
Luxury	
Total	

Show any workings here:

Past paper	
Answer	

[4]

12. Damyan sells cakes in the shape of a cylinder.

The diameter of each cake is 15 centimetres (cm)

Damyan puts a ribbon around the outside of each cake.

Each ribbon needs to be 56% longer than the distance around the cake.

How long does each ribbon need to be?

Use $\pi = 3.14$

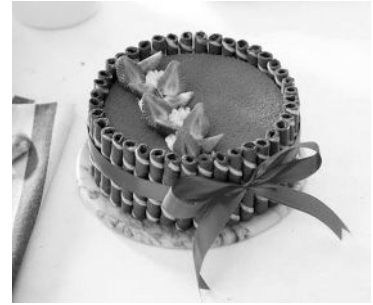

Blank area for writing the answer.

Answer		cm
---------------	--	-----------

[4]

Questions continue on the following page

13. Riley wants to buy milk from a local farm.

The farm has these prices on its website:

Glass bottles
£1 per pint

Plastic bottles
£2.30 for a 2-litre bottle

Which type of bottle is better value for money?

Use 1 litre = 1.76 pints

Show how you decide.

Answer area for the question. A large watermark "Past paper" is visible diagonally across the page.

Answer	
---------------	--

[4]

14. Lei needs to paint this wall three times:

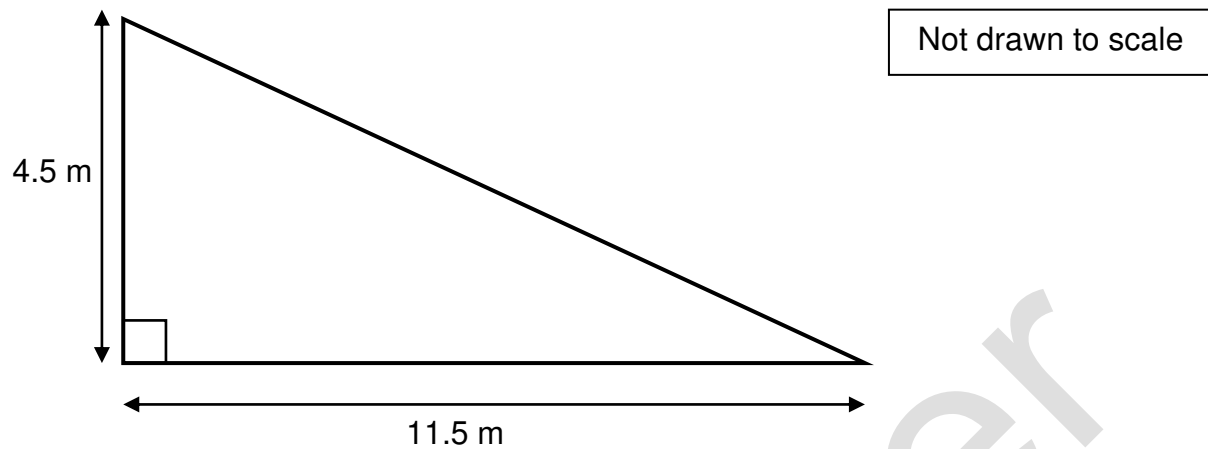

Paint is available in these colours:

Colour	White	Grey	Black	Charcoal	Cream
Number of square metres one tin will cover	14 m ²	12 m ²	8 m ²	6 m ²	13 m ²

Lei chooses the colour that will cover the median number of square metres.

How many tins of paint does Lei need to paint the wall three times?

Show your working.

Answer box is on the following page

--

Answer

tins

[5]

15. Kass owns a cleaning company.

Kass uses this table to record time spent at each cleaning job:

Time (t) in minutes	Number of cleaning jobs
$0 < t \leq 60$	11
$60 < t \leq 120$	36
$120 < t \leq 180$	18
$180 < t \leq 240$	5

Kass thinks the mean amount of time per cleaning job is less than 104.75 minutes.

Is Kass correct?

Show your working.

Answer box is on the following page

--

Answer	
---------------	--

[6]

This is the end of the assessment.

Past Paper



Ready to Take Your Functional Skills Exam?

Exam Centre is offering Ofqual-regulated, City & Guilds approved Functional Skills Maths and English exams; the nationally recognised GCSE grade 4+ (grade C) equivalent. Whether you're sitting for the first time or resitting, we offer flexible exam bookings online and at our centre all year round.

 **Book Now!**

Book Your Exams & Courses

Qualification	Private Course	Online Exam	Exam in London
Functional Skills Maths Level 1 & 2	Enrol on Course	Book Online Exam	Book London Exam
Functional Skills English Level 1 & 2	Enrol on Course	Book Online Exam	Book London Exam

Why Exam Centre?

- Ofqual-regulated & fully accredited
- City & Guilds approved awarding body exams
- Accepted by employers, colleges, universities & apprenticeship providers
- Flexible online and in-person options across the UK
- Recognised GCSE Maths & English equivalent (grade 4+ / grade C)

CALL US FOR MORE INFORMATION:

 **020 7288 9020**

 booking@examcentre.co.uk

 www.examcentre.co.uk